

$\phi 30_{-0.01}^0$

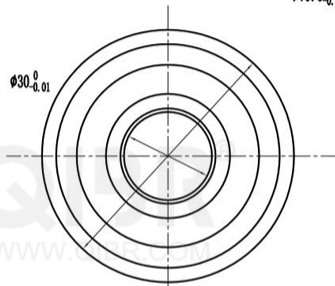

$\phi 79.5_{-0.1}^0$

$28.58 \pm 0.1$

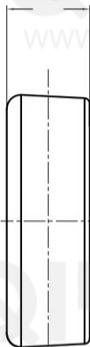

$16.6_{-0.12}^0$



**QIBR**<sup>®</sup>  
BEARINGS

LUOYANG QIBR BEARING CO., LTD

<http://www.QIBR.com>

Forklift Mast Roller

PART NUMBER

QMR30EB3-79